

LINVILLE LAND HARBOR

EMERGENCY - 911 ADDRESSES

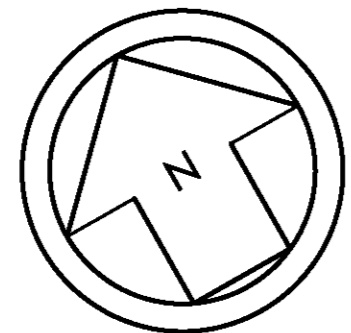

SCALE 1"=300'

LOCATION OF STREET NAMES

- ASH LOOP (LH) (14-275) D-3
- ASTER RD (A) (46-95) E-7
- AZALEA LN (HH) (11-103) B-6, A-6
- BALSAM LN (M) (27-138) C-7, C-8
- BEECH LN (D) (19-55) C-4, D-4
- BIRCH LN (M) (9-26) C-7
- BLACK PINE RD (A) (10-273) E-6, E-7, F-6, F-7
- BLUE JAY LN (B) (22-50) E-4
- BRIAR RD (B) (14-79) F-4, E-5
- BUTTERNUT LN (HH) (5-150) B-5
- CHESTNUT LN (A) (8-11) F-6
- CROSS RD (LH) (37) D-1, C-3, D-3
- DELPHINIUM LN (D) (21-261) C-4, C-5, D-5, D-4
- DEW DROP LOOP (M) (5-72) C-8
- DOGWOOD LN (D) (21-83) D-4, C-4
- ELDERBERRY LOOP (D) (17-398) D-5, D-4, C-4
- EVERGREEN LN (HH) (20-187) B-5, A-6, A-5
- FAIRWAY LN (GV) (10-236) D-4, C-4, C-3
- FAWN LN (M) (11-50) C-7
- FOX HILL LOOP (D) (25-240) C-5
- GALAX LOOP (LH) (31-241) C-3, D-3
- GOLDEN ROD LOOP (LM) (10-163) B-4, C-4, C-5
- GOLDFINCH RD (LH) (16-186) E-3, D-3
- GOLF RIDGE LN (GR) (11-139) D-5, D-6
- GOLFSW LN (GV) (20-53) D-4
- GOOSE HOLLOW RD (RK, B, D) (922-2067) B-4, C-4, D-4, D-5, E-5, E-6, F-6
- GREEN VALLEY LOOP (RR) (40-69) E-6
- GREENBRIAR LOOP (LH) (11-490) E-3
- GROSSBEAK RD (GV) (26-115) D-3
- GROUSE CIR (KR) (6-120) C-6
- HARBOR LAKE RD (C) (101-452) D-8, E-8, D-9, E-9
- HARBOR LN (C) (4-164) E-8, E-9
- HEMLOCK LOOP (D) (37-488) D-5, C-5, C-6
- HICKORY LN (D) (15-171) D-4, D-5
- HIGHLAND HILLS RD (HH & HC) (433-1026) C-5, C-6, B-5, B-6, A-5, A-6
- HILLCREST RD (HC) (6-208) A-5, A-6
- HOLLY LOOP (KR) (11-79) D-6
- HORNBEAM RD (LH) (17-199) D-3, D-4
- HUMMINGBIRD LN (LH) (21-125) C-2, C-3
- INDIAN PIPE RD (LH) (10-30) B-5, C-5, B-4
- IVY RD (LH) (18-575) D-2, D-3
- JACK PINE LOOP (HH) (20-489) B-6
- JEWEL LN (LH) (10-24) E-3
- JUNCO LN (GV) (8-34) D-4
- KEY FIELD LOOP (KR) (8-74) C-6
- KEY RIDGE RD (KR) (10-64) C-6
- KNOLL CIR (C) (7-278) D-8, E-8, E-9
- LADY SLIPPER (M) (20-280) C-8
- LAKEVIEW RD (LV) (24-471) D-6, D-7, E-7

- LAND HARBOR PKWY (GR) (1241) C-6, C-7, D-5, D-6, D-7, D-8, D-9, D-4
- LARCH LN (HH) (19-81) B-5, B-6
- LARKSPUR RD (A) (10-100) E-6
- LAUREL BROOK RD (LB & B) (102-339) E-5, E-4, D-4
- LAUREL HILLS RD (LH & HA HE) (185-514) C-2, C-3, D-7, D-3
- LAUREL LN (HH) (11-257) B-5, A-5
- LAUREL RD (LH) (11-99) C-3
- LOCUST RD (LH & GV) (10-707) C-3, D-3, D-4, E-3
- LONGVIEW RD (LH) (6-180) C-2, C-3, D-3
- MAY APPLE RD (GR) (28-86) D-5, D-6
- MEADOW LOOP (LM) (12-218) B-4, B-5
- MOUNTAIN VIEW LN (HA HE) (10-154) D-1, C-1
- OAK HILLS RD (D) (92-442) D-5, E-4, C-5
- OAK LN (LH) (44-181) D-3
- OVERLOOK RD (A) (10-74) E-6, E-7
- OWEN LN (HH) (16-44) A-6
- PARADISE RIDGE LN. (LE) (41-263) B-2, C-1, B-1
- PARK LOOP (A) (8-168) E-7, F-7
- PEPPERIDGE LN (HH) (7-193) A-6, B-5, B-6
- PINE LOOP (HH) (10-205) C-6
- PINE RIDGE LOOP (PR) (10-218) E-6
- PINE VALLEY RD (A) (25-300) E-6, E-6
- PINEVIEW RD (M) (57-140) D-7, D-8, C-7, C-8
- PLUMTREE LN (B) (25-71) E-5
- POKE RD (LH) (25) D-3
- POWDERHORN LN (B) (8-166) E-5, F-5
- QUAIL LANE (GV) (33-40) D-3, E-3
- RED OAK RD (RK) (25-279) B-3, B-4, C-3
- RHODODENDRON LOOP (RV) (21-272) E-5, E-6
- RICHARD CHILDRESS RD (GV) (1340) C-3, C-4

- RIDGE LN (C) (37) E-9
- RIDGE RD (HA HE) (120-640) C-1, C-2, D-2
- RIDGEWOOD LN (B) (6-68) E-5
- RIVER HOLLOW RD (HH) (115-528) B-6, C-6
- RIVER LOOP (HH) (7-212) B-6, C-5, C-6
- RIVER RD (LH) (31-300) B-4, C-4, C-5, B-5
- RIVER VIEW LN (RB) (12-26) C-5
- ROBIN CIR (B) (10-90) F-4
- ROCKY MEADOWS RD (B) (38-218) E-4, E-5, F-4
- SARVIS LN (LH) (22-37) D-7
- SASSAFRAS RD (A & PR) (27-159) E-6
- SHAGBARK LN (LH) (17-147) D-3
- SNOWSHOE LOOP (B) (3-355) E-5
- SOURWOOD KNLS (HH) (9-224) B-6, C-6
- SPRING BROOK RD (D) (40-321) C-6, D-5, D-6
- SPRUCE LN (D) (25-71) D-4, D-4
- SPRUCE PINE RD (D) (11-220) D-5, C-5
- STONY CREEK LOOP (GV) (23-303) C-3, D-3
- SUNSHINE LN (B) (12-154) E-4, E-5
- SUNSHINE LN (100) C-9, D-9
- TAMARACK RD (B) (33-325) E-5, F-5, E-4
- TEABERRY LN (D) (33-325) D-5, C-5, C-6, D-6
- THORNWOOD LOOP (B) (29-154) E-5, E-4
- TRILLIUM RD (A) (25-274) F-6, F-7
- TROUT BROOK LOOP (LB) (78-555) E-4, F-4, E-5
- TULIP LN (RK) (70-140) B-4, C-4
- TWINTREE LN (B) (6-46) F-5
- VALEY LN (A) (7-230) E-6, E-7
- WARBLER LN (GV) (37-61) D-4, E-4
- WHISPERING PINE LOOP (D) (7-209) D-5, C-5
- WILLOW LOOP (HA HE & LH) (14-183) C-2, D-2
- WINDMILL LN (GV) (21-161) C-3
- WINDRIDGE RD (HH) (10-693) B-5, C-5, B-6
- WINTERGREEN LN (HH) (11-156) B-5, B-6
- WOODCLIFF LOOP (M) (15-269) D-7, C-7
- WOODPECKER LN (LB) (15-59) D-4, E-4
- YARROW CIR (B) (12-119) F-5, F-6
- YEW LOOP (KR) (7-55) C-5, C-7

LOCATION OF FACILITIES & AMMENITIES

- ADMINISTRATION - L.H. PLAZA - D-8
- A BATHHOUSE - PINE VALLEY RD. - F-6
- B BATHHOUSE - TAMARACK RD. - F-5
- BILLIARD - OVERLOOK RD. - E-8
- D BATHHOUSE - OAK HILLS RD. - D-5
- DAM - HARBOR LN. - E-8
- GOLF HOUSE - L.H. PKWY & RICHARD CHILDRESS RD. D-5
- GOLF MAINTENANCE - RICHARD CHILDRESS RD. - D-4
- HH BATHHOUSE - PEPPERIDGE LN. - B-6
- LM BATHHOUSE - RIVER RD. - B-5
- MAINTENANCE - RICHARD CHILDRESS RD. - D-4
- SECURITY / LIBRARY / MBR SERVICES - L.H. PLAZA - D-8
- POINT PARK - L.H. PKWY. - C-7, D-7
- RECREATION HALL - L.H. PLAZA. - D-7
- RV STORAGE HWY 221 - C-9
- SEWER PLANT - OVERLOOK RD. - E-8
- SHUFFLEBOARD COURTS - OVERLOOK RD. - E-8
- TENNIS COURTS - OVERLOOK RD. - E-7
- TENNIS COURTS - REC HALL. - D-7

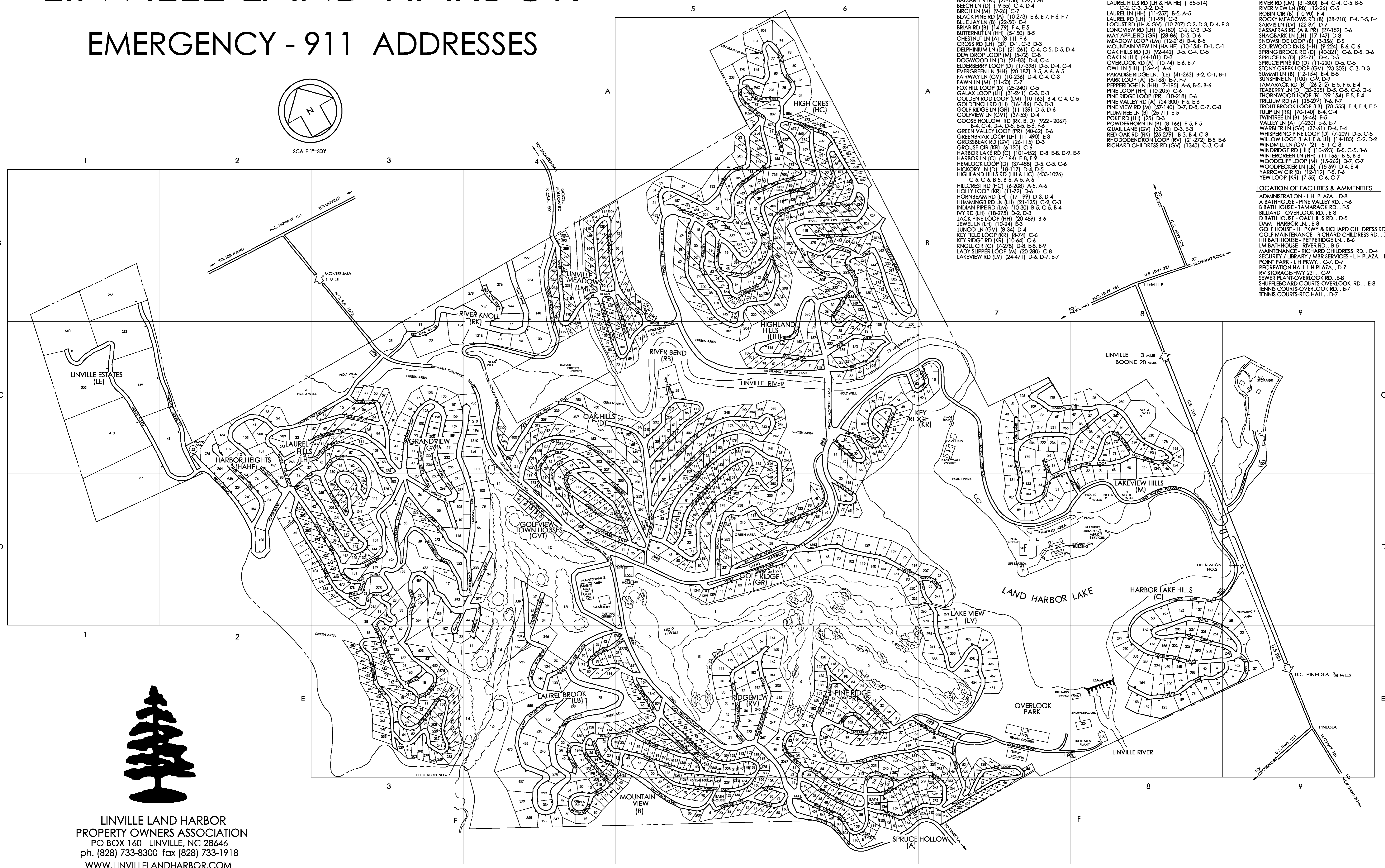

LINVILLE LAND HARBOR
 PROPERTY OWNERS ASSOCIATION
 PO BOX 160 LINVILLE, NC 28646
 ph. (828) 733-8300 fax (828) 733-1918
 WWW.LINVILLELANDHARBOR.COM